

# Ford Motability

Price Guide

3 Year Contract Hire Prices

Effective 1st July - 30th September 2025



Premium Paint and Rear Parking Sensors will be included as Free Options, where not standard, on all new Ford cars contracted through the Motability Scheme by a Ford Authorised Dealer (if not already included as Standard). This offer excludes Exclusive body colours. Where Exclusive colours are available to order, they are at additional cost. For details and availability, refer to the retail price list or consult your Ford Dealer. No cash alternative is available. Vehicle shown is an Explorer and is for illustration purposes only.



# Introduction and Contents

## Contents

---

Motability Contract Hire Policy	3
Electric Technology	4
Recommended Offers	5
Focus	6
Puma	8
New All-Electric Puma Gen-E	9
Kuga	10
New All-Electric Explorer	11
New All-Electric Capri	12
Mustang Mach-E	13
Tourneo Courier	14
Tourneo Connect	15
Tourneo Custom	16
Dealer Fit Accessories	17



## About Motability Scheme

---

The Motability Scheme delivers a worry-free mobility solution for disabled people by exchanging their Mobility Allowance to lease a vehicle through the Scheme. Motability Customers receive an all-inclusive service, so you do not need to worry about securing insurance, MOTs or repairs.

## Series Overview

---

### Zetec

The combination of integrated technologies and wide range of engine choices, makes Zetec an appealing entry series.

### Sport

Including ST-Line, ST-Line X

The eye-catching sporty design features of the ST-Line are further enhanced with additional technologies; the power embodied in ST Series complete a truly dynamic driving experience. ST-Line X offers an expanded list of features included as standard compared to ST-Line.

### Luxury

Including Titanium, Titanium X

The Ford luxury models deliver superior levels of sophistication and comfort, with premium materials, additional technologies and unique styling elements. Vignale is the ultimate expression of luxury.

### Crossover

Including Active and Active X

With its rugged SUV-inspired styling, the new Active crossover brings a heightened sense of adventure to the Ford range. Active X offers an expanded list of features included as standard compared to Active.

---

To find out more, visit [ford.co.uk/motability](https://ford.co.uk/motability), call 0345 60 40 019 or contact your local Ford Motability Dealer.

Vehicle shown is a Puma and is for illustration purposes only.

# Ford Motability Contract Hire Policy

## Payment Terms Glossary

---

DLA / PIP and AFIP	Disability Living Allowance - Higher Rate Mobility Supplement
PIP	Personal Independence Payments
AFIP	Armed Forces Independence Payments
WPMS	War Pensioners Mobility Supplement
CDP	Child Disability Payment (Scotland)
ADP	Adult Disability Payment (Scotland)
Advance Payment	The amount payable at the start of the 3-year Contract Hire period
Weekly Allowance = T/A	Total Weekly Allowance

## Fuel Consumption

---

The fuel consumption and CO<sub>2</sub> emission figures shown in the table are derived from the Worldwide Harmonised Light Vehicle Test Procedure (WLTP). These figures may not reflect real life driving results, which will depend upon a number of factors including the accessories fitted, variations in weather, driving styles and vehicle load. The figures shown are for comparability purposes; only compare fuel consumption and CO<sub>2</sub> figures with other vehicles tested to the same technical procedures. You can also use Ford's online configurator to build and customise a new Ford vehicle: [www.ford.co.uk/configurator](http://www.ford.co.uk/configurator). The configurator provides information about your configured vehicle's fuel consumption and CO<sub>2</sub> emissions (these are also WLTP test figures).

**For latest fuel consumption data, please refer to the relevant retail customer price guide.**

---

The declared Fuel/Energy Consumptions, CO<sub>2</sub>-Emissions and Electric range are determined according to the technical requirements and specifications of the European Regulations (EC) 715/2007 and (EU) 2017/1151 as last amended. Light Duty Vehicles type-approved using the World Harmonised Light Vehicle Test Procedure (WLTP) have Fuel/Energy Consumptions and CO<sub>2</sub>-Emission information for both New European Drive Cycle (NEDC) and WLTP. WLTP is a new, more realistic test procedure for measuring fuel consumption and CO<sub>2</sub> emissions and replaced the NEDC at the end of 2020. The applied standard test procedure enables comparison between different vehicle types and different manufacturers. In addition to the fuel efficiency of a car, driving behaviour as well as other non-technical factors play a role in determining a car's fuel/energy consumption, CO<sub>2</sub> emissions and electric range. CO<sub>2</sub> is the main greenhouse gas responsible for global warming. A guide on fuel economy and CO<sub>2</sub> emissions which contain data for all new passenger car models is available at any point of sale free of charge or can be downloaded under <https://carfueldata.vehicle-certification-agency.gov.uk/>. For Plug-In Hybrid (PHEV) models, these figures were obtained using a combination of battery power and fuel. PHEV models require an electricity source for charging. For All-Electric vehicles this is based on full charge. Estimated range using Worldwide Harmonised Light Vehicle Test Procedure (WLTP). Figures shown are for comparability purposes and should only be compared with other vehicles tested to the same technical procedures. Actual range varies with conditions such as external elements like temperature, driving behaviours, vehicle maintenance, and lithium-ion battery age. WLTP Overall Range reflects a combined driving cycle and WLTP Extra High reflects motorway driving – both tests are conducted in controlled conditions with an ambient temperature of 23 degrees Celsius and no climate or electrical load.

## Notes and Conditions

---

Applications must be received and accepted by Motability Operations Limited between 1st July and 30th September 2025.

All vehicles require the total allowance to be committed for the 3 year contract period and any subsequent increases in the allowance are forfeited.

Where a monetary value is shown, any subsequent increases in the allowance will be paid by the DWP to the recipient.





Prices are true and accurate at the time of publishing. Prices change from time to time.

Ford Motor Company Ltd. reserve the right to change prices without prior notification.

Offers available on selected dealer stock only. Please contact a participating Ford dealer for more information.

# ELECTRIC TECHNOLOGY

## Which electric engines is right for you?

	<p><b>MILD HYBRID (MHEV)</b> A small electric motor that helps improve efficiency versus a conventional internal combustion engine. Mild Hybrid vehicles have two sources of power that work together – a conventional engine and a battery - driven electric motor. The electric motor does not power the car. It simply assists it.</p>
	<p><b>HYBRID (HEV)</b> Hybrid vehicles have two sources of power. They can automatically switch between conventional mode, pure electric mode (for short distances) or use both to power the vehicle as needed.</p>
	<p><b>PLUG-IN HYBRID (PHEV)</b> Plug In. Charge up. Improves Efficiency versus a mild hybrid or hybrid engine. Plug-in Hybrids have the two sources of power like a hybrid, but with a larger high voltage battery, enabling you to drive longer distances on all-electric power.</p>
	<p><b>ALL-ELECTRIC (BEV)</b> 100% Electric. Just charge it up and go. All-Electric cars are powered by electricity alone. This means they have to be charged before you can drive.</p>

## Electric range

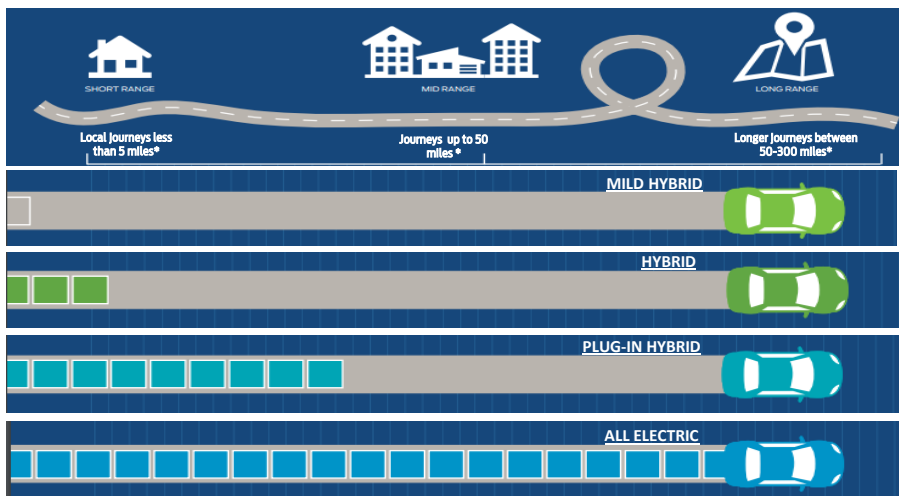

\* Ranges are estimates only and depend on the vehicle, road conditions and driving behaviour.

## Charging the battery

### MILD HYBRID AND HYBRID

There's no need to plug in your vehicle for charging. Hybrid vehicles are able to recharge the battery in two ways:

- 1) Regenerative braking
- 2) Conventional engine

The conventional engine powers the generator which transforms mechanical energy into electrical energy to charge the battery.

### PLUG-IN HYBRID

The larger battery in Plug-in Hybrids can be plugged-in to charge. Once the battery is depleted, the vehicle behaves like a conventional hybrid with the engine running when required.

### ALL-ELECTRIC

All-Electric vehicles are powered by electricity alone and don't have a petrol engine. They must be plugged in to charge the battery.

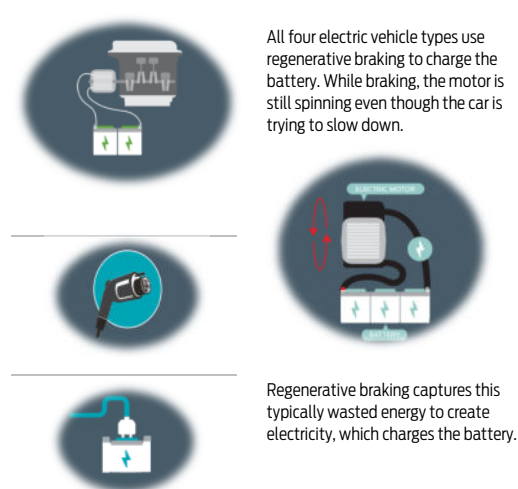

All four electric vehicle types use regenerative braking to charge the battery. While braking, the motor is still spinning even though the car is trying to slow down.

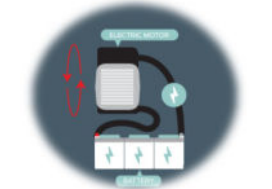

Regenerative braking captures this typically wasted energy to create electricity, which charges the battery.

## Plug in charging options

### 230V Wall outlet

Plug-in Hybrids and All-Electric vehicles can be charged on a 230V outlet, which is the standard electrical socket in most UK houses. This takes longer than when using a Wall box.

### Wall box

For faster charging at home you can install a compatible wall box, which is capable of charging your vehicle overnight.

### Public charging stations

Public charging stations, available in many cities and work places, can charge your vehicle much faster than at home. They can deliver an 80% charge in just 30 minutes. The price and charging capability can vary.

### IONITY High-power charging stations

400 charging stations will be capable of delivering faster charging of up to 350 kWh per hour across Europe (charging speed dependent on other factors including vehicle charging capability). These stations will be compatible with both current and future Ford electric vehicles. These are currently being built.

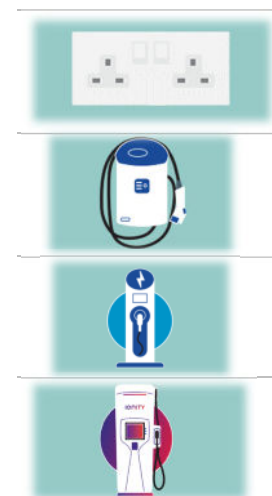

Ford Recommended Offers

						DLA, PIP, AFIP, CDP & ADP		
Bodystyle	Model	Series	Engine	Fuel	Transmission	Advance Payment	Weekly Payment	Key Features
Small SUV 5 door 5 seats	Puma	Titanium	1.0L Ford EcoBoost Hybrid (mHEV) 125PS	Petrol	Manual	£0	T/A	17" Alloy Wheels with an Absolute Black and Machined Finish, Cruise Control with Intelligent Speed Assist, All-new front grill with integrated Ford badge, Large 12" centre display
Large SUV 5 door 5 seats	Kuga	Active	2.5L Duratec 180PS Self Charging Hybrid	Petrol/Electric Hybrid	Automatic	£1,495	T/A	19" Active Alloy Wheels with an Absolute Black and Machined Finish 12-Way Ergonomic Power Adjust Driver and Passenger Seat with Memory Quickclear heated windscreen
Large SUV 5 door 5 seats	New All-Electric Explorer	Style	52 kWh Standard Range RWD	All Electric	Automatic	£0	T/A	19" Alloy Wheels (Aero / Absolute Black / Bright Machined) Heated Driver and Passenger Seat with Massage Function 7-Speaker Sound System Inc Soundbar 14.6" SYNC Move Touchscreen
		Select	77kWh Extended Range RWD	All Electric	Automatic	£1,295	T/A	19" Alloy Wheels (Aero / Absolute Black / Bright Machined) Heated Driver and Passenger Seat with Massage Function 7-Speaker Sound System Inc Soundbar 14.6" SYNC Move Touchscreen
		Premium	52 kWh Standard Range RWD	All Electric	Automatic	£1,595	T/A	20" Alloy Wheels - Aero / Magnetic / Bright Machined Panoramic Roof Hands-Free Power-Operated Liftgate Premium 10-Speaker B&O Sound System
		Premium	77kWh Extended Range RWD	All Electric	Automatic	£2,295	T/A	20" Alloy Wheels - Aero / Magnetic / Bright Machined Panoramic Roof Hands-Free Power-Operated Liftgate Premium 10-Speaker B&O Sound System
Large SUV 5 door 5 seats	New All-Electric Capri	Style	52 kWh Standard Range RWD	All Electric	Automatic	£245	T/A	19" Alloy Wheels (Aero / Absolute Black / Bright Machined) Heated Driver and Passenger Seat with Massage Function 7-Speaker Sound System Inc Soundbar 14.6" SYNC Move Touchscreen
		Select	77kWh Extended Range RWD	All Electric	Automatic	£1,545	T/A	19" Alloy Wheels (Aero / Absolute Black / Bright Machined) Heated Driver and Passenger Seat with Massage Function 7-Speaker Sound System Inc Soundbar 14.6" SYNC Move Touchscreen
		Premium	52 kWh Standard Range RWD	All Electric	Automatic	£1,845	T/A	20" Alloy Wheels - Aero / Magnetic / Bright Machined Panoramic Roof Hands-Free Power-Operated Liftgate Premium 10-Speaker B&O Sound System
		Premium	77kWh Extended Range RWD	All Electric	Automatic	£2,545	T/A	20" Alloy Wheels - Aero / Magnetic / Bright Machined Panoramic Roof Hands-Free Power-Operated Liftgate Premium 10-Speaker B&O Sound System

Why Ford?

The Ford Motability scheme was set up in 1977 to help disabled people, their families and carers get mobile. Since then, we have supplied over half a million Motability vehicles. We have an extensive range of vehicles to choose from, including Hybrid and electrified vehicles, alongside the latest technology and innovation. Our Motability scheme is available to both drivers and non-drivers, who we can offer a test ride in a vehicle of their choice. Premium Paint and Rear Parking Sensors are included as Free Options (where not standard) on all new Ford cars contracted through the Motability Scheme. With dedicated Motability Specialists we will take care of everything for you, including completing all paperwork. If you are currently not comfortable visiting, you can contact your local Ford Motability dealership and one of our dedicated specialists will discuss your options and what they can do to assist (or alternatively go to our website and request a contact from your local Ford dealership). Every step of the way, we make sure you're as comfortable and as sure as you can be when choosing the vehicle that's right for you.

# Focus

2024 to 2024.5 Model Year

Available from £1495 Advance Payment



## Dealer Stock Units Only

Series	Bodystyle	Engine	Fuel	Transmission	CO2 Emissions (g/km) for latest MY shown	DLA, PIP, AFIP, CDP & ADP		WPMS	
						Advance Payment	Weekly Payment	Advance Payment	Weekly Payment
Titanium	5 door	1.0L EcoBoost 125PS mHEV	Petrol	Manual	118	£2,695	T/A	£1,333	T/A
		1.0L EcoBoost 155PS mHEV	Petrol	Automatic	119	£3,545	T/A	£2,183	T/A
	Estate	1.0L EcoBoost 125PS mHEV	Petrol	Manual	120	£2,145	T/A	£783	T/A
		1.0L EcoBoost 155PS mHEV	Petrol	Automatic	121	£2,695	T/A	£1,333	T/A
Titanium X	5 door	1.0L EcoBoost 125PS mHEV	Petrol	Manual	118	£2,895	T/A	£1,533	T/A
		1.0L EcoBoost 155PS mHEV	Petrol	Automatic	119	£3,695	T/A	£2,333	T/A
	Estate	1.0L EcoBoost 125PS mHEV	Petrol	Manual	121	£2,345	T/A	£983	T/A
		1.0L EcoBoost 155PS mHEV	Petrol	Automatic	122	£2,895	T/A	£1,533	T/A
Active X	5 door	1.0L EcoBoost 125PS mHEV	Petrol	Manual	123	£2,645	T/A	£1,283	T/A
		1.0L EcoBoost 155PS mHEV	Petrol	Automatic	125	£3,345	T/A	£1,983	T/A
	Estate	1.0L EcoBoost 125PS mHEV	Petrol	Manual	125	£1,945	T/A	£583	T/A
		1.0L EcoBoost 155PS mHEV	Petrol	Automatic	126	£2,595	T/A	£1,233	T/A
ST-Line	5 door	1.0L EcoBoost 125PS mHEV	Petrol	Manual	119	£2,145	T/A	£783	T/A
		1.0L EcoBoost 155PS mHEV	Petrol	Automatic	120	£2,945	T/A	£1,583	T/A
	Estate	1.0L EcoBoost 125PS mHEV	Petrol	Manual	124	£1,495	T/A	£133	T/A
		1.0L EcoBoost 155PS mHEV	Petrol	Automatic	125	£2,145	T/A	£783	T/A
ST-Line X	5 door	1.0L EcoBoost 125PS mHEV	Petrol	Manual	121	£2,595	T/A	£1,233	T/A
		1.0L EcoBoost 155PS mHEV	Petrol	Automatic	124	£3,245	T/A	£1,883	T/A
	Estate	1.0L EcoBoost 125PS mHEV	Petrol	Manual	126	£1,895	T/A	£533	T/A
		1.0L EcoBoost 155PS mHEV	Petrol	Automatic	127	£2,545	T/A	£1,183	T/A

Any orders or applications placed against model years not in the price list are at dealer's own risk.

# Focus

25.75MY

Available from £1495 Advance Payment



					CO2 Emissions (g/km) for latest MY shown	DLA, PIP, AFIP, CDP & ADP		WPMS	
Series	Bodystyle Engine		Fuel	Transmission		Advance Payment	Weekly Payment	Advance Payment	Weekly Payment
ST-Line	5 door	1.0L EcoBoost 125PS mHEV	Petrol	Manual	119	£2,145	T/A	£783	T/A
		1.0L EcoBoost 155PS mHEV	Petrol	Automatic	120	£2,945	T/A	£1,583	T/A
	Estate	1.0L EcoBoost 125PS mHEV	Petrol	Manual	124	£1,495	T/A	£133	T/A
		1.0L EcoBoost 155PS mHEV	Petrol	Automatic	125	£2,145	T/A	£783	T/A

Any orders or applications placed against model years not in the price list are at dealer's own risk.



# Puma

2024.75 to 2025.75 Model Year  
Available from £Nil Advance Payment



Series	Bodystyle	Engine	Fuel	Transmission	CO2 Emissions (g/km) for latest MY shown	DLA, PIP, AFIP, CDP & ADP		WPMS	
						Advance Payment	Weekly Payment	Advance Payment	Weekly Payment
Titanium	5 door	1.0L Ford EcoBoost Hybrid (mHEV) 125PS	Petrol	Manual	121	£0	T/A	£0	£79.37
		1.0L Ford EcoBoost Hybrid (mHEV) 125PS	Petrol	Automatic	129	£395	T/A	£0	£82.05
ST-Line	5 door	1.0L Ford EcoBoost Hybrid (mHEV) 125PS	Petrol	Manual	122	£495	T/A	£0	£82.72
		1.0L Ford EcoBoost Hybrid (mHEV) 125PS	Petrol	Automatic	130	£795	T/A	£0	£84.75
ST-Line X	5 door	1.0L Ford EcoBoost Hybrid (mHEV) 125PS	Petrol	Manual	122	£795	T/A	£0	£84.75
		1.0L Ford EcoBoost Hybrid (mHEV) 125PS	Petrol	Automatic	130	£1,095	T/A	£115	£86.00
		1.0L Ford EcoBoost Hybrid (mHEV) 155PS	Petrol	Automatic	129	£1,095	T/A	£115	£86.00
ST	5 door	1.0L Ford EcoBoost Hybrid (mHEV) 170PS	Petrol	Automatic	135	£2,195	T/A	£833	T/A

Any orders or applications placed against model years or VTNs not in the price list are at dealer's own risk.



# New All-Electric Puma Gen-E

2025.5 - 2025.75 Model Year  
Available from £1645 Advance Payment



Series	Bodystyle	Powertrain	Fuel	Transmission	WLTP Extra High Range (Miles)	WLTP Combined Range (Miles)	CO2 Emissions (g/km) for latest MY shown	DLA, PIP, AFIP, CDP & ADP		WPMS	
								Advance Payment	Weekly Payment	Advance Payment	Weekly Payment
Select	5 door	43 kWh RWD	All Electric	Automatic	172	233	0	£1,645	T/A	£283	T/A
Select (Comfort Pack)	5 door	43 kWh RWD	All Electric	Automatic	172	233	0	£1,995	T/A	£389	T/A
Select (Advanced Driver Assistance Pack)	5 door	43 kWh RWD	All Electric	Automatic	172	233	0	£2,245	T/A	£139	T/A
Select (Advanced Driver Assistance Pack & Comfort Pack)	5 door	43 kWh RWD	All Electric	Automatic	172	233	0	£2,595	T/A	£1,233	T/A
Premium	5 door	43 kWh RWD	All Electric	Automatic	167	226	0	£2,645	T/A	£1,283	T/A
Premium (Advanced Driver Assistance Pack)	5 door	43 kWh RWD	All Electric	Automatic	167	226	0	£3,145	T/A	£1,783	T/A

Please note that the Advance Payment details listed above do not include the cost of Wall Box.  
Any orders or applications placed against model years not in the price list are at dealer's own risk.

# Kuga

2024.5-25.75 Model Year  
Available from £1495 Advance Payment



					CO2 Emissions (g/km) for latest MY shown	DLA, PIP, AFIP, CDP & ADP		WPMS	
Series	Bodystyle	Engine	Fuel	Transmission		Advance Payment	Weekly Payment	Advance Payment	Weekly Payment
Titanium	5 door	1.5L EcoBoost 150PS	Petrol	Manual	145	£1,795	T/A	£433	T/A
ST-Line	5 door	1.5L EcoBoost 150PS	Petrol	Manual	147	£2,595	T/A	£1,233	T/A
		2.5L Duratec 180PS FHEV	Self Charging Hybrid	Automatic	123	£1,995	T/A	£633	T/A
		2.5L Duratec 243PS PHEV	Plug-In Hybrid	Automatic	21	£5,995	T/A	£4,633	T/A
ST-Line X	5 door	1.5L EcoBoost 150PS	Petrol	Manual	154	£2,995	T/A	£1,633	T/A
		2.5L Duratec 180PS FHEV	Self Charging Hybrid	Automatic	131	£2,595	T/A	£1,233	T/A
		2.5L Duratec 183PS FHEV (AWD)	Self Charging Hybrid	Automatic	136	£3,995	T/A	£2,633	T/A
		2.5L Duratec 243PS PHEV	Plug-In Hybrid	Automatic	23	£6,795	T/A	£5,433	T/A
Active	5 door	2.5L Duratec 180PS FHEV	Self Charging Hybrid	Automatic	125	£1,495	T/A	£133	T/A
		2.5L Duratec 183PS FHEV (AWD)	Self Charging Hybrid	Automatic	0	£3,095	T/A	£1,733	T/A
		2.5 Duratec 243PS PHEV	Plug-In Hybrid	Automatic	21	£5,495	T/A	£4,133	T/A
Black Package	5 door	2.5L Duratec 180PS FHEV	Self Charging Hybrid	Automatic	128	£3,045	T/A	£1,683	T/A
		2.5L Duratec 183PS FHEV (AWD)	Self Charging Hybrid	Automatic	0	£3,995	T/A	£2,633	T/A
		2.5 Duratec 243PS PHEV	Plug-In Hybrid	Automatic	23	£7,245	T/A	£5,883	T/A

Please note that the Advance Payment details listed above do not include the cost of Wall Box.  
Any orders or applications placed against model years or VTNs not in the price list are at dealer's own risk.

# New All-Electric Explorer

2024.75-2025.75 Model Year  
Available from £Nil Advance Payment



Series	Bodystyle	Powertrain	Fuel	Transmission	WLTP Extra High Range (Miles)	WLTP Combined Range (Miles)	CO2 Emissions (g/km) for latest MY shown	DLA, PIP, AFIP, CDP & ADP		WPMS	
								Advance Payment	Weekly Payment	Advance Payment	Weekly Payment
Style	5 door	52 kWh Standard Range RWD	All Electric	Automatic	292	374	0	£0	T/A	£0	£79
Style (Driver Assistance Pack)	5 door	52 kWh Standard Range RWD	All Electric	Automatic	292	374	0	£995	T/A	£0	£86
Select	5 door	77 kWh Extended Range RWD	All Electric	Automatic	292	374	0	£1,295	T/A	£315	£86
Select (Driver Assistance Pack)	5 door	77 kWh Extended Range RWD	All Electric	Automatic	292	374	0	£1,995	T/A	£633	T/A
Premium	5 door	52 kWh Standard Range RWD	All Electric	Automatic	169	221	0	£1,595	T/A	£233	T/A
Premium (Driver Assistance Pack)	5 door	52 kWh Standard Range RWD	All Electric	Automatic	169	221	0	£2,295	T/A	£933	T/A
Premium	5 door	77 kWh Extended Range RWD	All Electric	Automatic	281	354	0	£2,295	T/A	£933	T/A
Premium (Driver Assistance Pack)	5 door	77 kWh Extended Range RWD	All Electric	Automatic	281	354	0	£2,995	T/A	£1,633	T/A

Please note that the Advance Payment details listed above do not include the cost of Wall Box.  
Any orders or applications placed against model years not in the price list are at dealer's own risk.

# New All-Electric Capri

2025 to 2025.75 Model Year  
Available from £245 Advance Payment



Series	Bodystyle	Powertrain	Fuel	Transmission	WLTP Extra High Range (Miles)	WLTP Combined Range (Miles)	CO2 Emissions (g/km) for latest MY shown	DLA, PIP, AFIP, CDP & ADP		WPMS	
								Advance Payment	Weekly Payment	Advance Payment	Weekly Payment
Style	5 door	52 kWh Standard Range RWD	All Electric	Automatic	299	389	0	£245	T/A	£0	£81
Style (Driver Assistance Pack)	5 door	52 kWh Standard Range RWD	All Electric	Automatic	299	389	0	£1,245	T/A	£265	£86
Select	5 door	77 kWh Extended Range RWD	All Electric	Automatic	299	389	0	£1,545	T/A	£183	T/A
Select (Driver Assistance Pack)	5 door	77 kWh Extended Range RWD	All Electric	Automatic	299	389	0	£2,245	T/A	£883	T/A
Premium	5 door	52 kWh Standard Range RWD	All Electric	Automatic	181	231	0	£1,845	T/A	£483	T/A
Premium (Driver Assistance Pack)	5 door	52 kWh Standard Range RWD	All Electric	Automatic	181	231	0	£2,545	T/A	£1,183	T/A
Premium	5 door	77 kWh Extended Range RWD	All Electric	Automatic	288	369	0	£2,545	T/A	£1,183	T/A
Premium (Driver Assistance Pack)	5 door	77 kWh Extended Range RWD	All Electric	Automatic	288	369	0	£3,245	T/A	£1,883	T/A

Please note that the Advance Payment details listed above do not include the cost of Wall Box.  
Any orders or applications placed against model years not in the price list are at dealer's own risk.

# Mustang Mach-E

2024 Model Year  
Available from £4495 Advance Payment



Series	Bodystyle	Powertrain	Fuel	Transmission	WLTP Extra High Range (Miles)	WLTP Combined Range (Miles)	CO2 Emissions (g/km) for latest MY shown	DLA, PIP, AFIP, CDP & ADP		WPMS	
								Advance Payment	Weekly Payment	Advance Payment	Weekly Payment
2024 Select	5 door	72 kWh Standard Range RWD	All Electric	Automatic	233	292	0	£4,495	T/A	£3,133	T/A
2024 Select with Tech Pack +	5 door	72 kWh Standard Range RWD	All Electric	Automatic	233	292	0	£5,495	T/A	£4,133	T/A

Please note that the Advance Payment details listed above do not include the cost of Wall Box.  
Any orders or applications placed against model years not in the price list are at dealer's own risk.

# Tourneo Courier

2024.75 Model Year  
Available from £1495 Advance Payment



Series	Bodystyle	Engine	Fuel	Transmission	CO2 Emissions (g/km) for latest MY shown	DLA, PIP, AFIP, CDP & ADP		WPMS	
						Advance Payment	Weekly Payment	Advance Payment	Weekly Payment
Titanium	Tourneo	1.0L Ford EcoBoost 125PS, FWD*	Petrol	Manual	152	£1,495	T/A	£133	T/A
	Tourneo	1.0L Ford EcoBoost 125PS, FWD*	Petrol	Automatic	156	£1,995	T/A	£633	T/A
Active	Tourneo	1.0L Ford EcoBoost 125PS, FWD*	Petrol	Manual	153	£1,695	T/A	£333	T/A
	Tourneo	1.0L Ford EcoBoost 125PS, FWD*	Petrol	Automatic	157	£2,195	T/A	£833	T/A

Any orders or applications placed against model years not in the price list are at dealer's own risk.

# Tourneo Connect

2024.5 to 2025.5MY Model Year  
Available from £2995 Advance Payment



Dealer Stock Units Only

Series	Bodystyle	Engine	Fuel	Transmission	CO2 Emissions (g/km) for latest MY shown	DLA, PIP, AFIP, CDP & ADP		WPMS	
						Advance Payment	Weekly Payment	Advance Payment	Weekly Payment
Titanium	Tourneo	1.5L EcoBoost 115PS	Petrol	Automatic	152	£2,995	T/A	£1,633	T/A
		2.0L EcoBlue 122PS	Diesel	Automatic	146	£2,995	T/A	£1,633	T/A
		1.5L EcoBoost 150PS	Plug-In Hybrid	Automatic	11	£6,495	T/A	£5,133	T/A
	Grand Tourneo	1.5L EcoBoost 115PS	Petrol	Automatic	156	£3,495	T/A	£2,133	T/A
		2.0L EcoBlue 122PS	Diesel	Automatic	150	£3,495	T/A	£2,133	T/A
		1.5L EcoBoost 150PS	Plug-In Hybrid	Automatic	12	£7,295	T/A	£5,933	T/A
Titanium Add Third Row Seats*	Tourneo	1.5L EcoBoost 115PS	Petrol	Automatic	153	£3,295	T/A	£1,933	T/A
		2.0L EcoBlue 122PS	Diesel	Automatic	146	£3,295	T/A	£1,933	T/A
Titanium Delete Third Row Seats**	Grand Tourneo	1.5L EcoBoost 115PS	Petrol	Automatic	158	£3,495	T/A	£2,133	T/A
		2.0L EcoBlue 122PS	Diesel	Automatic	139	£3,495	T/A	£2,133	T/A
Active	Tourneo	2.0L EcoBlue 122PS	Diesel	Automatic	146	£3,295	T/A	£1,933	T/A
		1.5L EcoBoost 150PS	Plug-In Hybrid	Automatic	11	£6,995	T/A	£5,633	T/A
	Grand Tourneo	2.0L EcoBlue 122PS	Diesel	Automatic	149	£3,795	T/A	£2,433	T/A
		1.5L EcoBoost 150PS	Plug-In Hybrid	Automatic	12	£6,995	T/A	£5,633	T/A
Active Add Third Row Seats*	Tourneo	2.0L EcoBlue 122PS	Diesel	Automatic	146	£3,495	T/A	£2,133	T/A

Any orders or applications placed against model years not in the price list are at dealer's own risk.

\* Note: For Add Third Row Seats please select THIRD ROW DUAL INDIVIDUAL SEAT - WERS BYCAJ

\*\* Note: For Delete Third Row Seats please select DELETE PACK CATEGORY A#1 - WERS AG5AB. (3rd Row Pre-Equipment Pack - WERS BYCBJ - Is for WAV converters and will not pay)



Tourneo Custom

2024.5 -2025.75 Model Year

Available from £6945 Advance Payment



Series	Bodystyle	Engine	Fuel	Transmission	CO2 Emissions (g/km) for latest MY shown	DLA, PIP, AFIP, CDP & ADP		WPMS		VTN
						Advance Payment	Weekly Payment	Advance Payment	Weekly Payment	
Zetec	L1	65kWh, RWD	All Electric	Automatic	0	£6,945	T/A	£5,583	T/A	665716
Titanium	L1	65kWh, RWD	All Electric	Automatic	0	£6,945	T/A	£5,583	T/A	667194
Titanium Luxe	L1	65kWh, RWD	All Electric	Automatic	0	£7,445	T/A	£6,083	T/A	667193
Active	L1	65kWh, RWD	All Electric	Automatic	0	£7,745	T/A	£6,383	T/A	667192
Titanium X	L1	65kWh, RWD	All Electric	Automatic	0	£8,045	T/A	£6,683	T/A	667190
Titanium X Luxe	L1	65kWh, RWD	All Electric	Automatic	0	£8,345	T/A	£6,983	T/A	667189
Zetec	L2	65kWh, RWD	All Electric	Automatic	0	£7,645	T/A	£6,283	T/A	665714
Titanium	L2	65kWh, RWD	All Electric	Automatic	0	£7,645	T/A	£6,283	T/A	667188
Titanium Luxe	L2	65kWh, RWD	All Electric	Automatic	0	£8,145	T/A	£6,783	T/A	667187
Active	L2	65kWh, RWD	All Electric	Automatic	0	£8,445	T/A	£7,083	T/A	667186
Titanium X	L2	65kWh, RWD	All Electric	Automatic	0	£8,545	T/A	£7,183	T/A	667185
Titanium X Luxe	L2	65kWh, RWD	All Electric	Automatic	0	£8,845	T/A	£7,483	T/A	667184

Any orders or applications placed against model years not in the price list are at dealer's own risk.

## ACCESSORIES

For prices and more information about the dealer supplied Ford Accessories below or to view the full range of Ford Accessories visit [www.ford-accessories.co.uk](http://www.ford-accessories.co.uk)



### Tow Bars

- Choice of fixed, detachable & retractable tow bars
- Designed to ensure compatibility with your vehicle's electrical systems
- Enables Trailer Sway Control (part of ESP), where available
- Suitable for trailers, caravans and bike carriers



### Boot Liners & Load Compartment Mats

- Popular, 'must-have' accessories
- Help protect the carpet in your boot from dirt
- Tailored to fit your Ford
- Made from heavy-duty, non-slip materials
- Easy to clean



### Rubber Floor Mats

- Tailored to fit your Ford
- Help protect your vehicle's interior
- Easy to clean – simply remove and hose down
- Designed to avoid slipping & interference with the pedals
- Made from heavy-duty, non-slip materials



### Dashboard Cameras

- Discreet unobtrusive design
- In-car camera continually records ahead and to the rear of driver (if rear camera is installed)
- Can help provide video evidence in the event of an incident
- Wi-Fi compatible enabling control of camera features and recorded data via your mobile device



Click on your model.

Images for illustrative purposes and may vary. Fitment of dealer-fit parts and accessories may have an impact on your vehicle's fuel/ energy consumption.

This price list shows both original Ford accessories as well as a range of carefully selected products from third party suppliers, identified under that third party supplier's brand name. Please note that third party supplier branded accessories do not come with a Ford warranty but are covered by the third party supplier's own warranty, the details of which can be obtained from your Ford Dealer.

Accessories availability varies by model. Visit [www.ford-accessories.co.uk](http://www.ford-accessories.co.uk)